

Data Specs

4mm Banana Plugs - Cable Assembly

This standard 4mm banana plug with rigid screw on acetal body comes in range of red and black body colours for easy identifications. The plug pin comes with solder bucket for secure cable fixing with spring terminal.



Brief Data:

- 4mm standard banana male plug.
- Silver plated brass contacts.
- Acetal insulation.
- Nominal working voltage: 50VAC.
- Rated current of 10A.
- Maximum contact resistance is 10mΩ.
- Connector Mounting: Cable Mount.
- Conductor size: 1.5mm²
- Temperature: -20°C ~ 110°C.

Mechanical Dimension (mm):

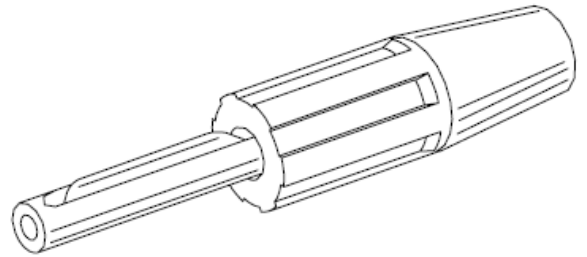
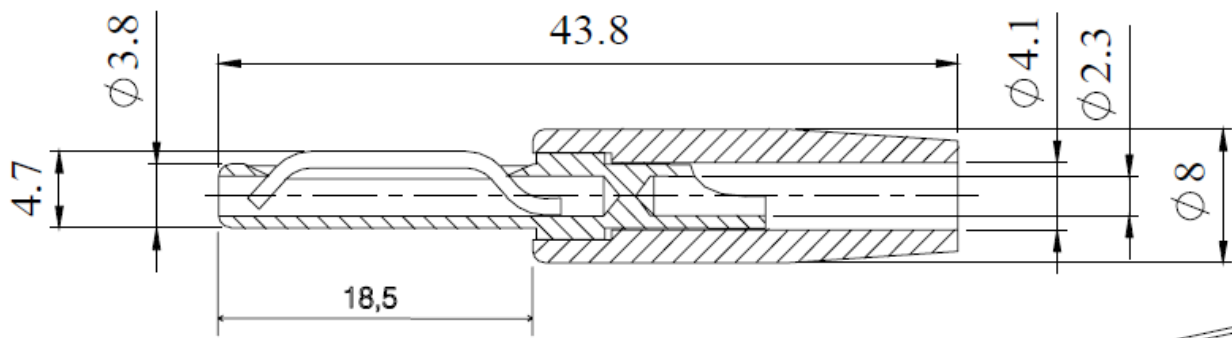

Web Resources:

- 1.